

DIVERTER COMPONENTS

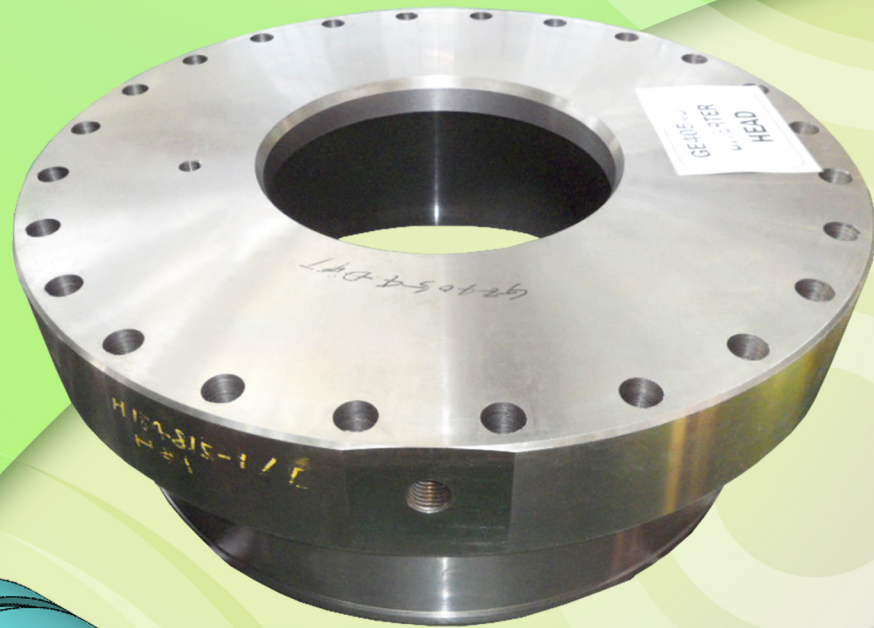

Head

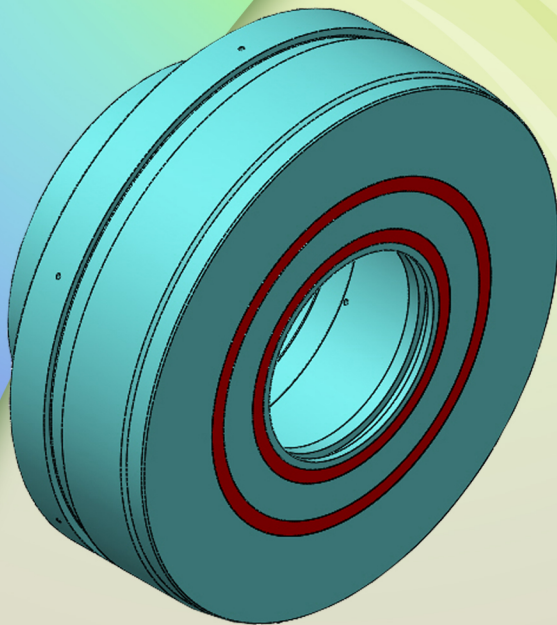

Body

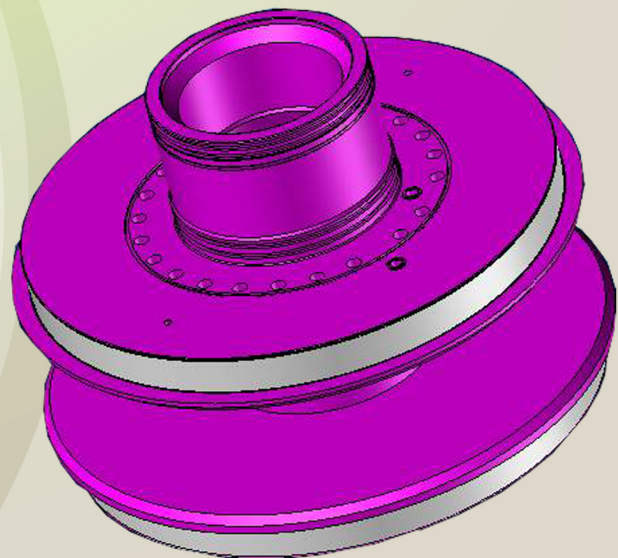

Middle Spool

Material : AISI 8630 M (Low Alloy Steel)

Weld Rod : ERNiCrMo-3

Welding

- Inconel 625 Overlay welding : Overlay welding is the method to overlay welding metal at least 1mm thick with anti-corrosiveness, anti-abrasion and heat-resistance onto the base metal. In case of Inconel 625, it has excellent steel properties of high temperature and heat-resistance as well as low temperature/high temperature acid-resisting fatigue strength, which is used as a welding metal with corrosion-resistance.

Machining (Body)

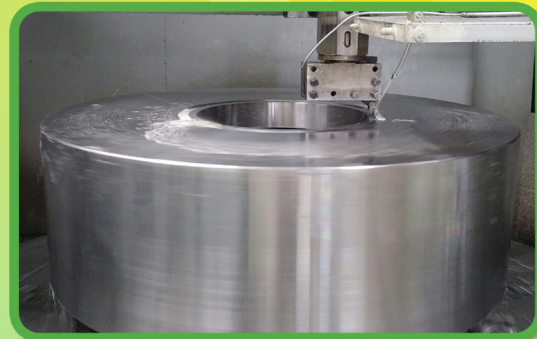

Phosphate Coating

- Phosphate coatings are a crystalline conversion coating that is formed on a ferrous metal substrate. Phosphate coating is employed for the purpose of pretreatment prior to coating or painting, increasing corrosion protection and improving friction properties of sliding components.
- Process: Pre-treatment -> Degreasing -> Washing -> Pickling -> Washing -> Phosphate Coating -> Cleaning -> Drying -> Inspection
- Phosphate Tank Size : W4,200 x L5,200 x H1,732
- Chemical Additives for Phosphate Coating : Accelerator 24, Additive 39, Gardobond 390, Gardoclean 543A, Gardoclean 543B, Gardolene P-Z, GB ADD 9951-1

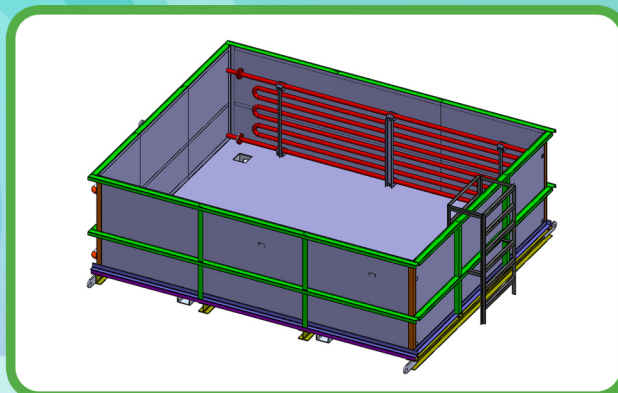

• Phosphate Tank

Head Office 4th FL, Cheongsan Bldg, 38, Seochojungang-ro 2-gil, Seocho-gu, Seoul, 137-864, Korea Tel. +82-2-583-9761

Gunsan Factory 72, Jayumyeok 2-gil, Gunsan-si, Jeonbuk, 573-540, Korea Tel. +82-63-472-7300

Gimje Factory 147, Yongji-ro, Yongji-myeon, Gimje-si, Jeonbuk, 576-972, Korea Tel. +82-63-542-8509

▶ E-mail : power@energyen.co.kr, business@energyen.co.kr

▶ Homepage : www.energyen.co.kr